

# Rockfield Farm Development Site, Undy— What people told us...

Monmouthshire County Council's Estates team hosted four engagement events across June 2015 to provide local residents with the opportunity to help guide development of the site via the Council's proposed Master Plan. The Plan which covers matters such as access, design layout, pedestrian/cycle/vehicle routes, open space, landscaping and links to wider community facilities, will be the subject of further consultation before adoption. Below is a summary of the feedback:



124  
People signed in at the events



106  
Feedback forms received

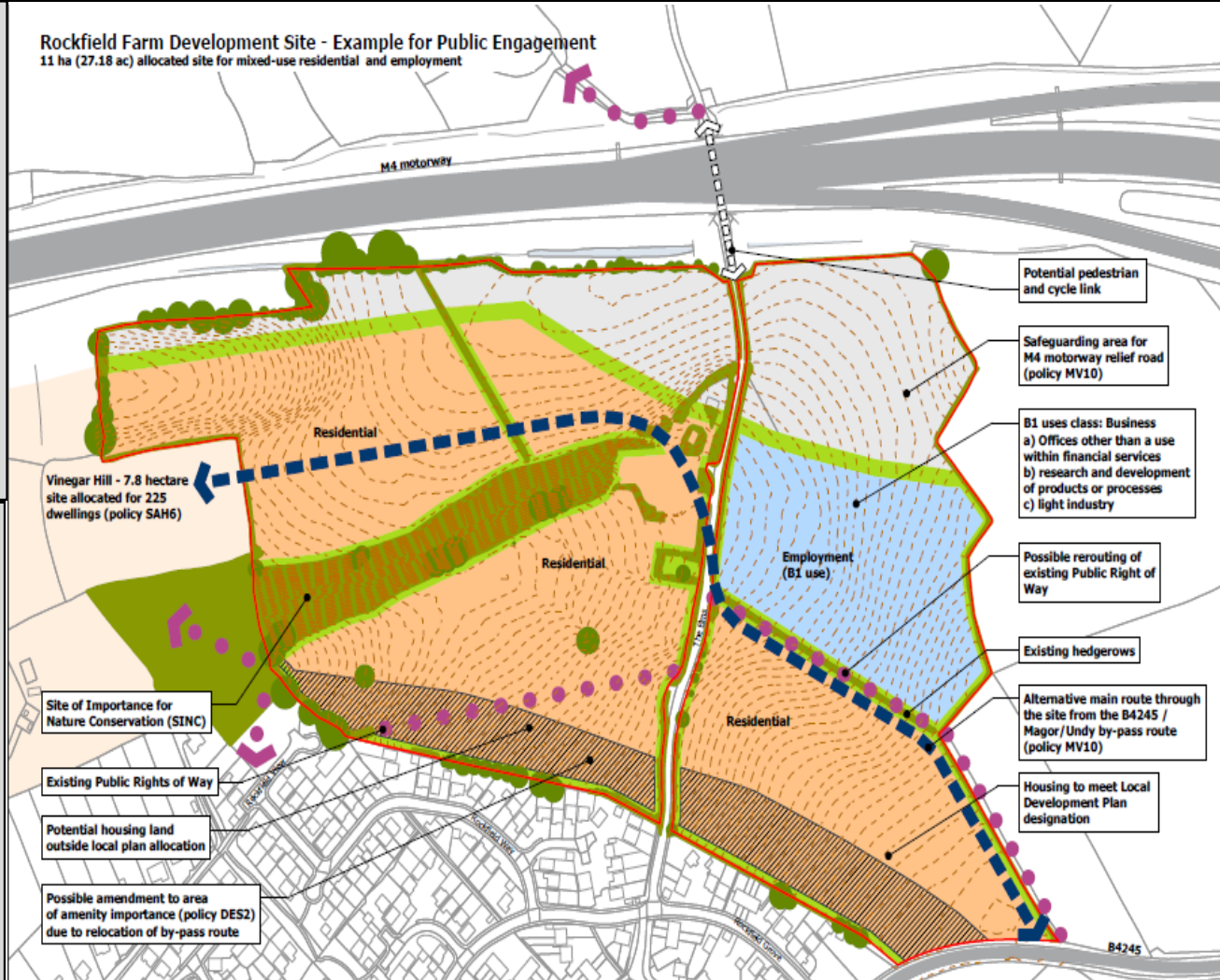

**61%**  
of respondents stated the **retention of existing trees and hedges** was the most important in terms of open space for the development.

**47%-56%**  
Of all respondents identified the need for better connection between the site, open space and local facilities for pedestrians.

**73%**  
of respondents would like to see S106 contributions put towards the proposed new community hall on the Three Fields Site.

**54%**  
of respondents identified **traffic calming measures** and **access to public transport** as main concerns regarding the development of the site.

Some respondents identified the importance of railway links including the opening of Magor train platform.

Numerous people referenced the importance of the bypass road and M4 junction to improve the existing traffic situation and avoid local congestion.

In terms of employment, none of the suggested activities were viewed favourably for the site.

**53%**  
of respondents identified the **provision of woodland** as an important part of the provision open space.

**Additional comments** received relate to the capacity of schools and medical facilities, community facilities on site and the wider area, the design and appearance of new homes and spaces, the protection of wildlife, trees and hedgerows on site, the need to strengthen local shopping and support facilities, traffic impact and management and the retention of a village character.