

Footway Works

Key

Charcon Woburn Rumbled
Block paving 60mm thick on
50mm sand bed

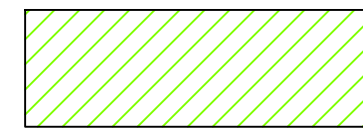

No works required

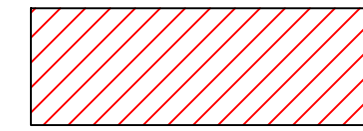

Charcon Countryside
Conservation kerbs

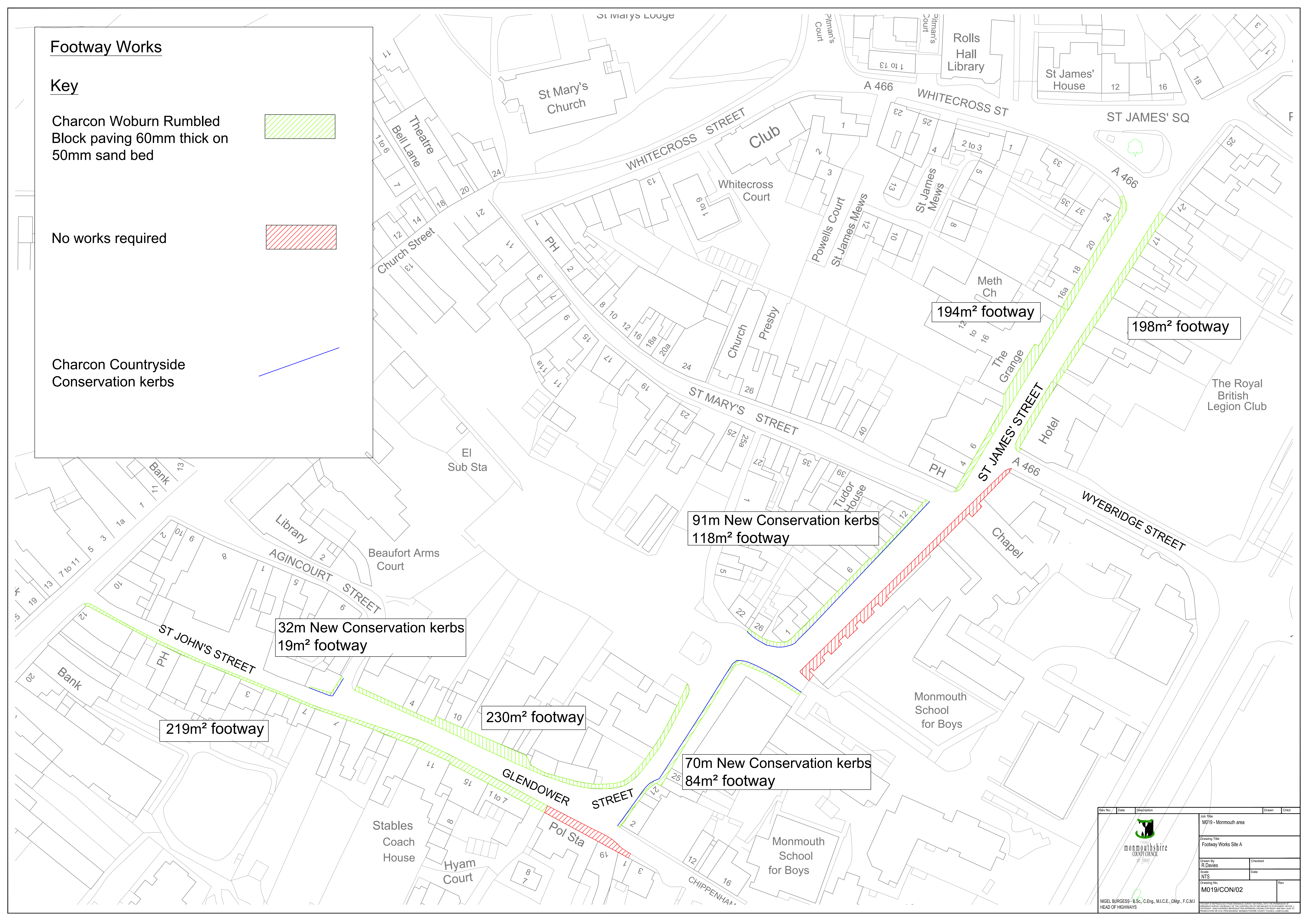
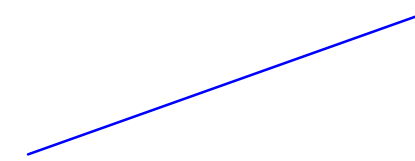

194m² footway

198m² footway

91m New Conservation kerbs
118m² footway

32m New Conservation kerbs
19m² footway

219m² footway

230m² footway

70m New Conservation kerbs
84m² footway

Rev No	Date	Description	Drawn	Chkd
		Job Title M019 - Monmouth area		
		Drawing Title Footway Works Site A		
Drawn By R.Davies		Checked Date		
Scale NTS				
Drawing No. M019/CON/02				
NIGEL BURGESS - B.Sc., C.Eng., M.I.C.E., C.Mgr., F.C.M.I. HEAD OF HIGHWAYS				